



LION

HYDRAULICALLY DRIVEN AIRLESS SPARY PAINTING EQUIPMENT

The range is designed for tough working conditions and Suitable for medium and high viscosity coatings from primer and finish paints to high build solvent-less coatings.

FEATURES

- Unique spring- detent less stall free high performance hydraulic motor.
- High Flow Rate.
- Stainless Steel rust proof Hydraulic body.
- Easy maintenance.
- Light & Easy to Handle.

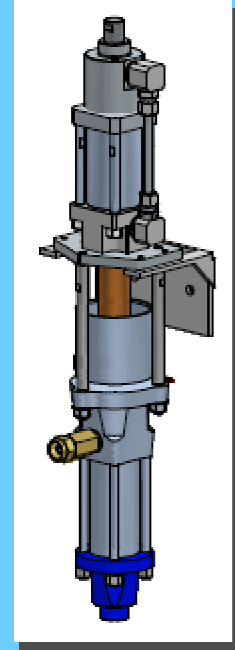

TECHNICAL SPECIFICATIONS

Type	H24.150	H33.110	H36.210	H39.275	H44.180	H45.210	H46.275
Equivalent Pneumatic Pump	Tiger 30.150	Tiger 40.110	Rhino 50.210	Rhino 55.275	Rhino 60.180	Rhino 75.210	Rhino 75.275
Output per Cycle	150 cc	110 cc	210 cc	275 cc	180 cc	210 cc	275 cc
Hydraulic Motor	D40	D40	D63	D63	D63	D63	D63
Stroke Length	120 mm	120 mm	120 mm	120 mm	120 mm	120 mm	120 mm
Pressure Ratio	1.85	2.50	3.40	2.40	3.95	3.40	2.40
Recommended Spray Volume @25 cycles per minute.	3.75 ltr.	2.75 ltr.	5.25 ltr.	6.87 ltr.	4.5 ltr.	5.25 ltr.	6.87 ltr.
Hydraulic Oil Inlet Pressure Max.	130 bar	130 bar	105 bar	160 bar	105 bar	130 bar	190 bar
Output Pressure Max.	240 bar	325 bar	357 bar	384 bar	434 bar	442 bar	456 bar
Oil Flow rate at 25 cycles/min	8 ltr.	8 ltr.	19 ltr.	19 ltr.	19 ltr.	19 ltr.	19 ltr.
Theoretical H.P. (Approx @ 85% efficiency)	3 HP	3 HP	5.5 HP	8 HP	5.5 HP	6.5 HP	10 HP



VR COATINGS PVT.LTD.

J-138,MIDC PUNE – 411 026,INDIA.

TEL: (020)30781022, 27130331 FAX : (020) 30781051,27495273

E-MAIL: vrcoatings@eth.net, sales@vrcoatings.com, Web : www.vrcoatings.com

